

# Storm Shield®

## Peel & Stick

easy  
DO-IT-YOURSELF  
installation

# 2

## Read All Directions Carefully Before Starting Work

### Required Materials:

- Storm Shield® - Peel & Stick Seal
- Utility Knife
- Acetone or Pine-Sol® or similar (Must be Dry)
- Lint Free Cloth
- Chalk Line
- Small Roller (if available)

### Weather Conditions:

- Do not apply Storm Shield® unless at least 50 Degree F
- Low Humidity

### General Notes:

- Storm Shield® should be room temperature for a period of no less than 24 hours.
- Storm Shield® must be applied to a smooth, dry, clean surface free from debris.

**DO NOT REMOVE LINER UNTIL STORM SHIELD® IS READY TO INSTALL. ONCE STORM SHIELD® COMES IN CONTACT WITH CONCRETE STORM SHIELD CANNOT BE RE-POSITIONED.**

### STEP-BY-STEP INSTALLATION PROCEDURE

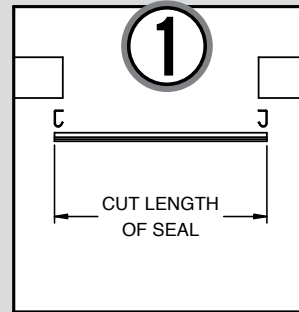

1. Lay Storm Shield® from vertical track to vertical track. If necessary, cut per dimension from outside of vertical track to outside vertical track.

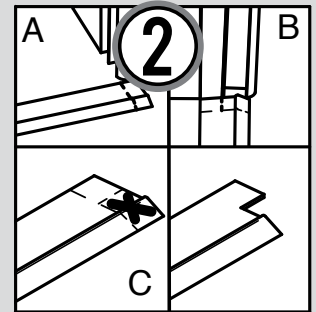

2a. Mark Storm Shield® to be notched by aligning end with outside of vertical track and marking in line with inside of track.  
2b. Align Storm Shield® with jamb against vertical track. Mark backside of vertical track as shown.  
2c. Cut X portion to notch Storm Shield®, repeat for other side.

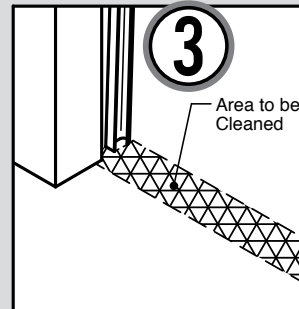

3. Use a lint free cloth to clean floor with Acetone, as it will aid in removing moisture from the surface of the concrete. If Acetone is not available, Pine-Sol® can be used. Note: If using Pine-Sol® floor must be completely dry before applying Storm Shield®.

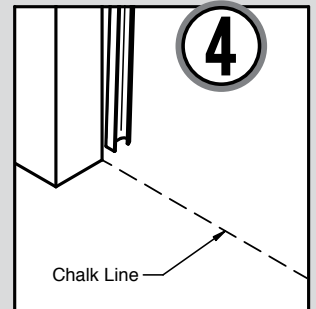

4. Snap a chalk line from jamb to jamb at the location that the door meets the opening when closed.

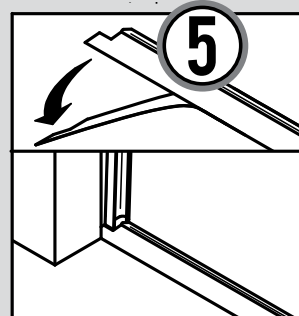

5. Install Storm Shield® along chalk line removing liner and patting the seal down 6-8" at a time. **ONCE STORM SHIELD® COMES IN CONTACT WITH THE CONCRETE IT CANNOT BE RE-POSITIONED.**



6. Garage door should be lowered on Storm Shield® and allow 24 hours for adhesive to take a set. Use a small roller to aid the adhesive in making contact with the floor if possible.