

VITECTOR

FRABA

IMPORTANT SAFETY INSTRUCTIONS

WARNING

To reduce the risk of injury or death to persons

- 1) **READ AND FOLLOW ALL INSTRUCTIONS**
- 2) Disconnect power supply before attempting installation
- 3) Be sure to have the gate/door fully open or fully closed before installing the RAY-N photo eye.
- 4) For use with a Class 2 supply +6V DC to +40V DC
- 5) For use as entrapment protection device on doors or gates
- 6) Refer to door or gate operator manual for details of accurate connection to the operator
- 7) RAY-N photo eyes are to be placed at the bottom of the opening no more than 6 inches (doors)/ 27.5 inches (gates) from the ground

8) SAVE THESE INSTRUCTIONS

Description

The RAY-N photo eye is an entrapment protection device to safeguard doors or gates acc. to the requirements of UL325.

Product Contains

One (1) RAY-N Receiver
One (1) RAY-N Transmitter
Two (2) L-Brackets for Mounting
One (1) Accessory Set for Mounting

Technical Data

Power Consumption max. 50 mA
Supply Voltage 6 to 40V DC
Operation Temp. -13°F to 165°F
Range:
Photo Eye 45 ft.

VITECTOR

FRABA

INSTALLATION RAY-N

Doors and Gates must be equipped with entrapment protection devices to avoid danger of injury to persons.

Doors

Install non-contact sensor in the door opening not higher than 6 in. from the ground

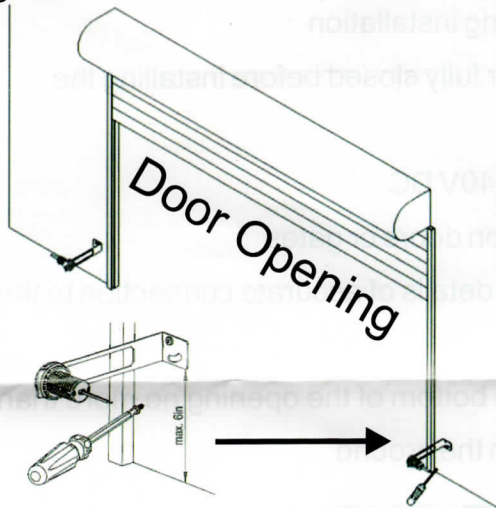

Gates

Install non-contact sensor in the gate opening not higher than 27 1/2 in. from the ground

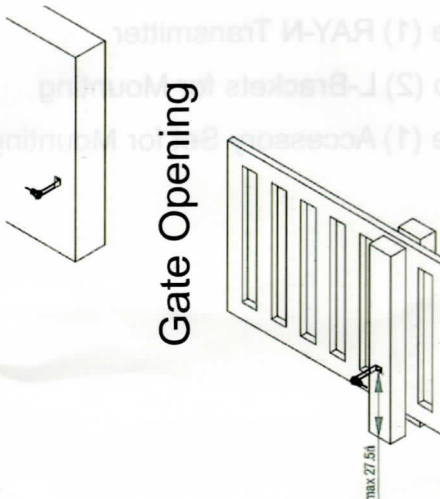

Bracket Mounting:

1. Mount sensors to bracket using washer and nuts provided.

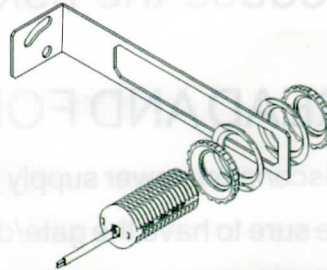

Be sure to fit bracket into the slot of the front washer

2. Wire photo eyes to the operator and connect to the monitored interface

Bracket Alignment:

Align transmitter and receiver by adjusting angle and height of the fixture

Angle Adjustment

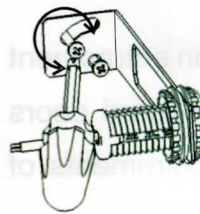

Height Adjustment (first loosen nuts)



For finer angle adjustment, loosen the nuts and position the photo-eye within the fixed bracket.

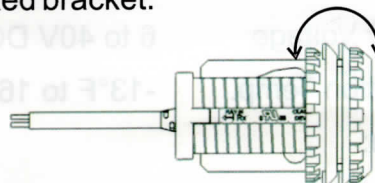

VITECTOR

FRABA

INSTALLATION RAY-N

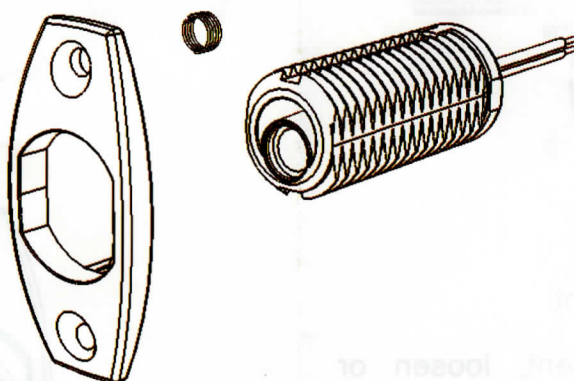
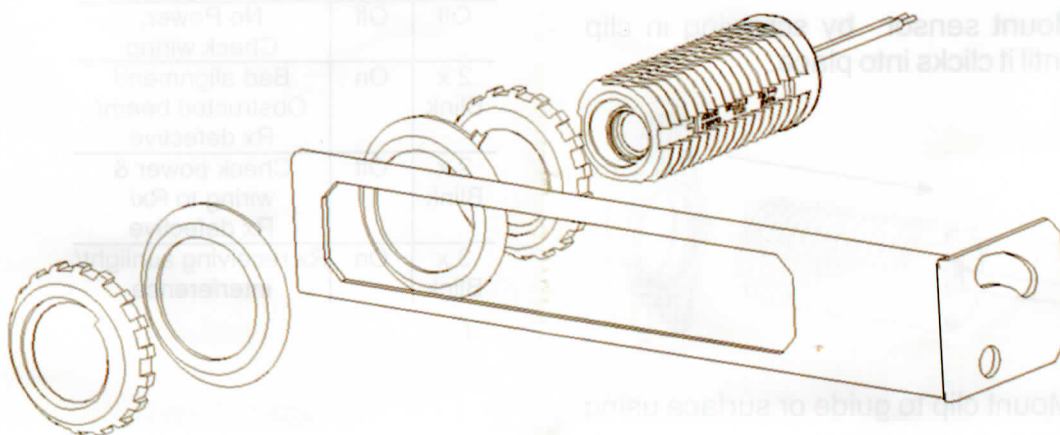

VITECTOR

FRABA

INSTALLATION RAY-N

The Clip Mount for flush mounting is available as an addition accessory for the RAY-N and may or may not be contained in this kit.

Flush Mounting with Clip:

1. Mount sensor by screwing in clip until it clicks into place.

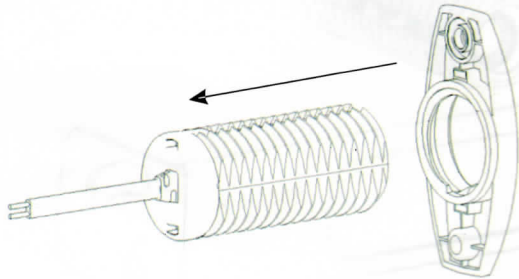

2. Mount clip to guide or surface using screws and spring.

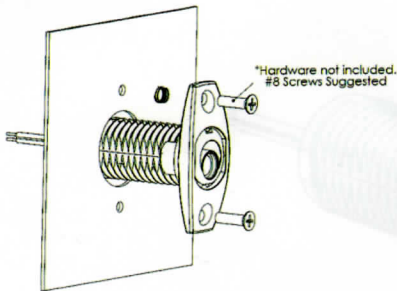

Flush Mount Alignment:

For angle adjustment, loosen or tighten the screw with the spring.

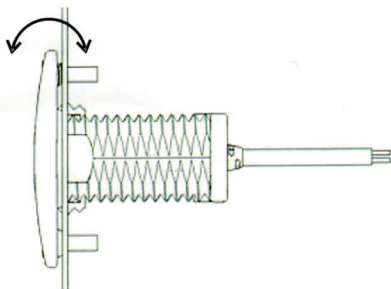

Utilize LED's for alignment and trouble-shooting:

Red LED	Green LED	Status
On	On	Normal Operation
Off	Off	No Power, Check wiring
2 x Blink	On	Bad alignment/ Obstructed beam/ Rx defective
2 x Blink	Off	Check power & wiring to Rx/ Rx defective
3 x Blink	On	Rx receiving sunlight/ interference

