



User Manual

3-Button Garage Door Remote Control Model: MM-318



1. INTRODUCTION

Thank you for your purchase of Skylink® remote transmitter, Model MM-318.

The following items are included in this package:

- One of MM-318 Remote
- Lithium Battery CR-2032 (Installed)
- Mounting accessories
- User's instructions

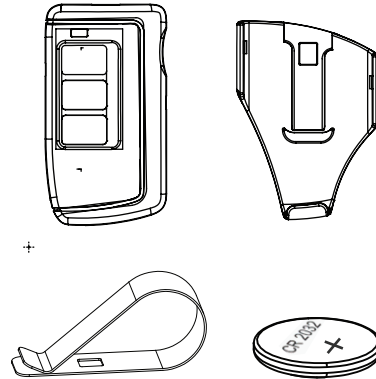

2. PROGRAMMING

Follow one or more instructions below to program transmitter MM-318 to the Skylink® receiver or Skylink® garage door opener you want to control.

2a. PROGRAMMING A REMOTE TRANSMITTER TO THE SKYLINK® GARAGE DOOR OPENER - ATOMS™ SERIES

1. Connect the opener to an approved power source. The dot in the LED segment stays on.	
2. Press the [Set] button for one second, and release the button until the LED segment shows the letter "P".	
3. Within 30 seconds, press any button on the remote that you would like to program to the opener.	
4. Once the button on the remote is programmed. The LED segment will go off and there will be one beep indicating the programming successfully.	

2b. PROGRAMMING A REMOTE TRANSMITTER TO THE SKYLINK® GARAGE DOOR OPENER - ATOMS™ SERIES

1. Connect the opener to an approved power source. The dot in the LED segment stays on.	
2. Press and hold the [Set] button on the wall console for 5 seconds.	
3. Press and hold the [Set] button twice and the remote icon will flash on the LCD display.	
4. Within 30 seconds, press any button on the remote that you would like to program to the opener.	
5. The garage door opener will beep if remote is successfully programmed and the flashing remote icon will change to solid.	

2c. PROGRAMMING A REMOTE TRANSMITTER TO THE SKYLINK® GARAGE DOOR OPENER - EQ AND IQ SERIES

To program the transmitter to the Skylink® EQ and IQ series Garage Door Opener, please follow the user's instruction from the Garage Door Opener.

2d. PROGRAMMING A REMOTE TRANSMITTER TO THE SKYLINK SMART BUTTON™ – GB-318.

To program the transmitter to the Skylink® Smart Button™, please follow the user's instruction from the Smart Button™.

2e. PROGRAMMING A REMOTE TRANSMITTER TO THE IN-CAR REMOTE SYSTEM

In order to remotely control the Skylink Garage Door Opener with your in car remote system, a transmitter must be programmed to your in car remote system. To program the transmitter to your in car remote system, a "Learn" code must be transmitted, follow the instructions below to transmit the "Learn" code to your in car remote system. Please disable the password feature in the Skylink Transmitter before programming to the in-car remote system.

1. Refer to the user's instructions of your in car remote system to put your in car remote into programming mode.
2. Press and hold the button on the Skylink transmitter you already programmed for 10 seconds to program to the car system. Release the button when the red LED changes from solid to flashing.
3. The red LED on the transmitter will be flashing for the next 20 seconds advising you to transmit the 'learn' code.
4. Once the transmitter is programmed, your in car remote system will quit from programming mode.

Your in car remote system is ready to be used.

2f. PROGRAMMING THE TRANSMITTER TO THE SKYLINKHOME™ PLUG-IN ON/OFF CONTROL – PG-318

1. Set the Plug-In On/Off Control in Programming mode. 2. Turn off the connected device/light. 3. Press and hold the 'SET' button for 3 seconds, the red LED will flash. 4. Release the 'SET' button. 5. Press any one of the 3 buttons on the transmitter that you want to program to the receiver. 6. Once the transmitter is programmed, the red LED flashes quickly then stops flashing. You have successfully programmed the transmitter.	
---	--

2g. PROGRAMMING THE TRANSMITTER TO THE SKYLINKHOME™ SCREW-IN CONTROL – LG-318

1. Turn off the light switch of the empty socket where you plan to install the Mini Screw-In Control.
2. Screw the Mini Screw-In Control to the empty socket.
3. Screw a light bulb to the fixture.
4. Power on the Mini Screw-in Control. It will beep.
5. It is now in programming mode and will stay in this mode for 15 seconds.
6. Press any one of the 3 buttons on the transmitter that you want to program to the receiver.
7. Once the transmitter is programmed, the Mini Screw-In Control will beep once and the connected device/light turn on. You have successfully programmed the transmitter.

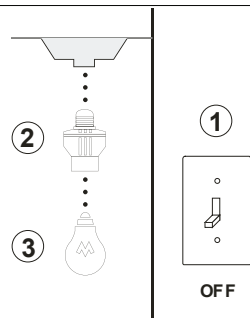

NOTE: If the receiver or control module you wish to program isn't listed here, please refer to the receiver's user manual for instructions.

3. OPERATION

Press the programmed button to open/close the garage door or receiver.

4a. ADVANCED FEATURE - ENABLE / DISABLE PASSWORD FEATURE

1. Press the buttons [1] and [3] simultaneously and hold for 2 seconds until the LED flashes quickly but not until the LED flashes slowly.
2. Input the password [factory default 2 2 2, input these by pressing the Button 2 three times].
3. Press [1] and [3] once simultaneously to confirm. If the password is correct, the password feature will be enabled / disabled.

Note:

[.] = Button 1, [..] = Button 2, [...] = Button 3

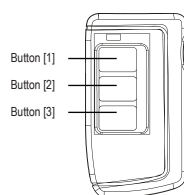

NOTE: If you enable the password feature, the remote can be password protected. You can only operate the remote after you input the correct password.

4b. ADVANCED FEATURE - CHANGE PASSWORD

1. Press the buttons [1] and [3] simultaneously and hold for more than 6 seconds until the LED changes from flashing quickly to flashing slowly.
2. Input the password [factory default 2 2 2, input these by pressing the Button 2 three times].
3. Press [1] and [3] once simultaneously to confirm. If the password is wrong, the LED will flash 3 times and you must start over from step 1.
4. Input new password. [e.g. 1 1 1, input these by pressing the Button 1 three times]
5. Press [1] and [3] once simultaneously to RE-confirm. The password has been changed.

Note: Password can be 2 – 8 digits long, which is a combination of 1, 2 and 3.

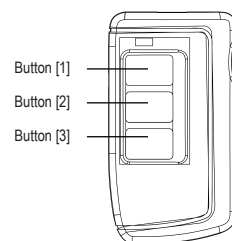

4c. ADVANCED FEATURE – RESET PASSWORD

1. Press the buttons [1] and [2] simultaneously and hold for more than 10 seconds until the LED flashes.
2. After you release the buttons [1] and [2], the LED will be turned off and the remote will be reset. The password will be reset to factory default.

After the reset, password protection is removed, and the remote cannot control any receiver or opener until you reprogram it to receiver or opener you want to control.

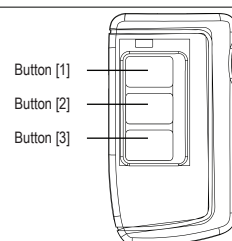

5. BATTERY REPLACEMENT

The remote come with a 3 Volt lithium battery (CR 2032) installed. It is time to change the battery when the red LED on the transmitter does not turn on when either button is pressed.

To replace the battery:

1. Remove the screw on the back of the remote.
2. Pry out the back cover from the remote
3. Take out the old battery.
4. Place the new battery in position. Be sure the polarity is correct.
5. Close the back cover with the screw.

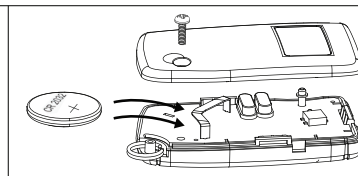

Battery Disposal - Dispose used battery according to local regulations.

6. FAQ

Q: What can I do if the door opener does not react after I press the button on the transmitter?

A: - Ensure when the button on the transmitter is pressed, the red light on the transmitter comes on. Otherwise, check if the battery is inserted properly.

- Make sure the correct button on the transmitter is pressed.
- Ensure the transmitter has been programmed to the receiver. Refer to section 2 for how to program a transmitter to the receiver.
- Ensure to input the correct password if the password protection is enabled.

7. FCC

This device complies with Part 15 of the FCC Rules. Operation is subject to the following two conditions: (1) This device may not cause harmful interference, and (2) This device must accept any interference received, including interference that may cause undesired operation.

WARNING:

Changes or modifications to this unit not expressly approved by the party responsible for compliance could void the user's authority to operate the equipment.

8. WARRANTY

If, within one year from date of purchase, this product should become defective (except battery), due to faulty workmanship or materials, it will be repaired or replaced, without charge. Proof of purchase and a Return Authorization are required.

9. CUSTOMER SERVICE

If you would like to

- find out the up-to-date specifications
- know more about features and applications
- download documents, i.e. user's instructions
- order Skylink products

or if you have difficulty getting products to work, please:

1. visit our FAQ section at www.skylinkhome.com, or
2. email us at support@skylinkhome.com, or
3. call our toll free at 1-800-304-1187 from Monday to Friday, 9 am to 5 pm EST. Fax 1-800-286-1320



CUSTOMER SERVICE

17 Sheard Avenue, Brampton, Ontario, Canada L6Y 1J3

Email: support@skylinkhome.com

<http://www.skylinkhome.com>

©2016 SKYLINK GROUP

P/N:101Y426 - ENG