

CHAMBERLAIN®

LiftMaster®

PROFESSIONAL

This addendum is to be used in conjunction with the owner's manual included with this operator. Refer to the manual for all mounting and wiring instructions. The damp environment modification includes a TEFC motor, watertight/oil tight control enclosure, watertight/oil tight 3-button control station, and nickel-plated chain in lieu of all standard components of the operator.

1. Refer to page 2 & 3 of addendum for electrical box replacement parts.
2. Refer to page 4 of addendum for control and power wiring connections for damp environment applications.

For all other installation instructions refer to owner's manual provided with operator.

WIRING DIAGRAM VARIANCES

1. This operator is in variance to the operator wiring diagram located in the cover of the operator. There is a ground wire from the electrical box to the motor. When replacing the motor the ground wire must be reconnected.
2. Owner's manual refers to the MAS or Maintenance Alert System LED, the 3-button station that is provided with this operator does not include the MAS LED.

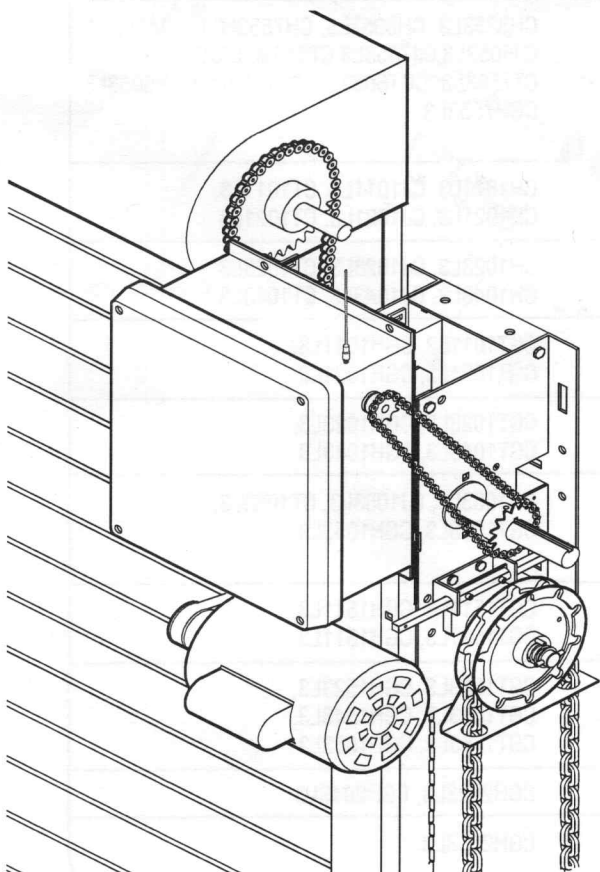

Model H
(Shown)

ADDENDUM

Damp Environment Operator with Logic 3.0

Models: T, GT, GH, H, and J

⚠ WARNING

Mechanical

⚡ WARNING

Electrical

CAUTION

When you see these Safety Symbols and Signal Words on the following pages, they will alert you to the possibility of **serious injury** or **death** if you do not comply with the warnings that accompany them. The hazard may come from something mechanical or from electric shock. Read the warnings carefully.

When you see this Signal Word on the following pages, it will alert you to the possibility of damage to your door and/or the door operator if you do not comply with the cautionary statements that accompany it. Read them carefully.

OPERATOR DIMENSIONS

Model	Overall Length	Overall Width	Overall Height
CJ	22.5"	16"	17"
CH	22.5"	16"	17"
CT	24" (plus door height)	16.5"	11.75"
CGT	20" (plus door height)	13.5"	18.75"
CGH	26.5"	13.5"	16.13"

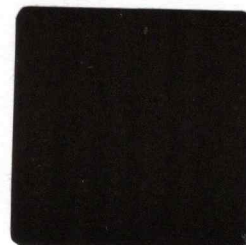

ELECTRICAL BOX LOGIC CONTROL (VER. 3.0)

COMPLETE ELECTRICAL BOX REPLACEMENT KITS

To order a complete electrical box replacement kit, add a K-prefix to the model number of your operator. For example:

CGH5011L3 = K-CGH5011L3

SERVICE KITS

ITEM	PART#	DESCRIPTION
K1	K72-12515-1	Limit Switch Assembly Kit Complete with: Limit nut retainer, spring nut plate, backup plate limit switch, screw #4-40 pan head, screw #4-40 pan head, screw #6-32 pan head, locknut #6-32
K2	K72-33192 & K72-33258 (CGT only)	Shaft Kits Complete with: Limit shaft, limit nuts, sprocket 48B18 x 3/8", sprocket 48B9 x 3/8" (CGT only), interrupter cup, shim washers, roll pin, e-rings, compression ring, push ring, flange bearings, bearing seals, neoprene gaskets

INDIVIDUAL PARTS

ITEM	PART #	DESCRIPTION
1	42-31247	Terminal block 3 pos.
2	10-32397	Mounting plate
3	21-14182	Transformer, 115/230 Volts
	21-35057	Transformer, 460 Volts
	21-35077	Transformer, 575 Volts
4	29-31244	Relay 24 VDC 600 DPST (A & B relay)
5	29-31229	Relay 24 VDC SPDT (1 Ph unit only) (C relay)
6	29-31245	Relay 12 VDC SPDT (3 Ph unit only) (C & D relay)
7	42-10040	Radio block
8	44-1210-4XD	Enclosure with cover
9	K1A5729	Logic board
10	K79-15016-1	RPM sensor
11	K1C3196-3	Antenna
12	23-10041	Limit switch
13	15-48B18AXX	Sprocket 48B18 x 3/8"
	15-48B9A1	Sprocket 48B9 x 3/8" (CGT only)

MOTORS

MOTOR	MODEL
20-1050B-2TLP	CH3311L3, CH5011L3, CJ3311L3, CJ5011L3, CT3311L3, CT5011L3, CH3321L3, CH5021L3, CJ3321L3, CJ5021L3, CT3321L3, CT5021L3
20-3050B-4T	CH3323L3, CH5023L3, CJ3323L3, CJ5023L3, CT3323L3, CT5023L3, CH3343L3, CH5043L3, CJ3343L3, CJ5043L3, CT3343L3, CT5043L3
20-1050C-2TLP	CGT5011L3, CGH5011L3, CGT5021L3, CGH5021L3
20-3050C-4T	CGT5023L3, CGH5023L3, CGT5043L3, CGH5043L3
20-1075B-2TLP	CH7511L3, CJ7511L3, CT7511L3, CH7521L3, CJ7521L3, CT7521L3
20-3075C-4T	CH7523L3, CJ7523L3, CT7523L3, CH7543L3, CJ7543L3, CT7543L3
20-3075B-4T	CH7523L3, CJ7523L3, CT7523L3, CH7543L3, CJ7543L3, CT7543L3
20-1075C-2TLP	CGT7511L3, CGH7511L3, CGT7521L3, CGH7521L3
20-3075C-4T	CGT7523L3, CGH7523L3, CGT7543L3, CGH7543L3
20-3075M-5T	CH3353L3, CH5053L3, CH7553L3, CJ3353L3, CJ5053L3, CJ7553L3, CT3353L3, CT5053L3, CT7553L3, CGT5053L3, CGT753L3, CGH5053L3, CGH7553L3
20-1100B-2TLP	CH1011L3, CJ1011L3, CT1011L3, CH1021L3, CJ1021L3, CT1021L3
20-3100B-4T	CH1023L3, CJ1023L3, CT1023L3, CH1043L3, CJ1043L3, CT1043L3
20-100C-2TLP	CGT1011L3, CGH1011L3, CGT1021L3, CGH1021L3
20-3100C-4T	CGT1023L3, CGH1023L3, CGT1043L3, CGH1043L3
20-3100M-5T	CH1053L3, CJ1053L3, CT1053L3, CGT1053L3, CGH1053L3
20-1150C-2TLP	CGT1511L3, CGH1511L3, CGT1521L3, CGH1511L3
20-3150C-4T	CGT1523L3, CGH1523L3, CGT1543L3, CGH1543L3, CGT1553L3, CGH1553L3
20-3200C-4TP	CGH2023L3, CGH2043L3
20-3200C-5T	CGH2053L3

REPAIR PARTS KITS - ELECTRICAL BOX LOGIC CONTROL 3

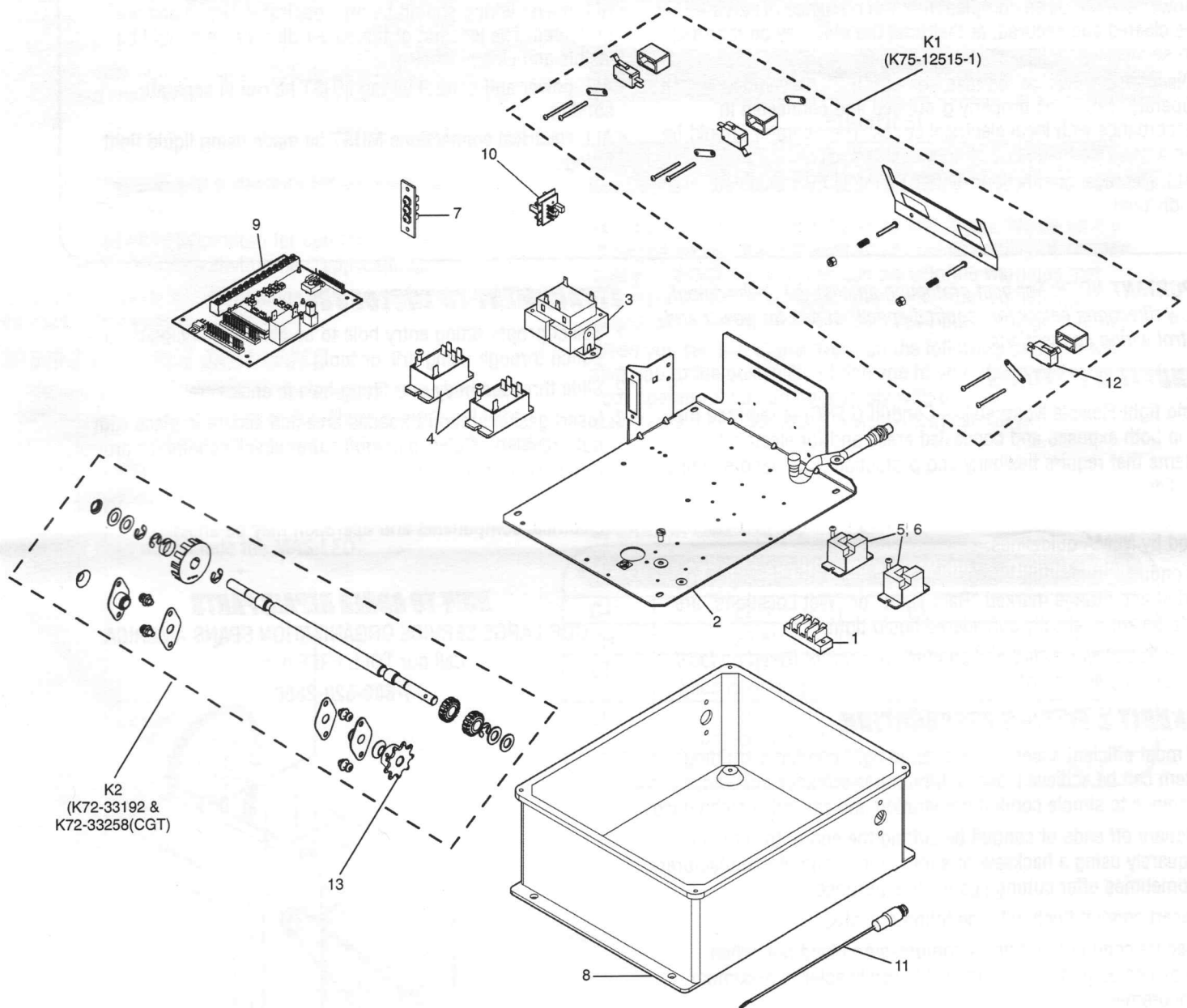

RECOMMENDED POWER AND CONTROL CONNECTIONS

WARNING

To reduce the risk of SEVERE INJURY or DEATH:

- ANY maintenance to the operator or in the area near the operator **MUST** not be performed until disconnecting the electrical power and locking-out the power via the operator power switch. Upon completion of maintenance the area **MUST** be cleared and secured, at that time the unit may be returned to service.
- Disconnect power at the fuse box **BEFORE** proceeding. Operator **MUST** be properly grounded and connected in accordance with local electrical codes. The operator should be on a separate fused line of adequate capacity.
- ALL electrical connections **MUST** be made by a qualified individual.

- DO NOT install ANY wiring or attempt to run the operator without consulting the wiring diagram. We recommend that you install an optional reversing edge **BEFORE** proceeding with the control station installation.
- ALL power wiring should be on a dedicated circuit and well protected. The location of the power disconnect should be visible and clearly labeled.
- ALL power and control wiring **MUST** be run in separate conduit.
- ALL electrical connections **MUST** be made using liquid tight fittings.

IMPORTANT NOTE: For best protection against the environment follow directions below for required specifications for power and control wiring connections.

CONDUIT & FITTINGS

Liquid tight Flexible Nonmetallics Conduit (LFNC) is required for use in both exposed and concealed areas and for electrical systems that require flexibility and protection from vapors, liquids or solids.

LFNC conduit should be used for liquid tight environment as stated by NEMA guidelines.

All conduit and conduit fittings should be marked as "Liquid Tight" conduit and fittings marked "Rain Tight" or "Wet Locations" are not to be automatically considered liquid tight.

NOTE: Select all conduit and conduit connectors based on local code and application of job.

CONDUIT & FITTING PREPARATION

The most efficient assembly of a liquid tight conduit and fitting system can be achieved, and optimum performance ensured, by adherence to simple conduit preparation and assembly techniques:

1. Square off ends of conduit by cutting the end of the conduit squarely using a hacksaw or similar tool, conduit manufacturers sometimes offer cutting jigs for this purpose.
2. Insert conduit flush with the fitting end stop.
3. Secure conduit to fitting. A compression gland nut, when provided as part of a fitting, will typically achieve maximum securement.
4. Ensure conduit jacket is not cut or ripped in any location along its surface.

NOTE: For conduit preparation, always follow the conduit manufacturer's instructions.

ATTACHMENT TO ENCLOSURE

1. Select proper fitting entry hole to be placed in enclosure and punch through using drill or tool.
2. Slide threaded body into fitting hole in enclosure,
3. Insert gasket around threaded area and secure in place with nut provided. (Refer to manufacturer specifications for proper torque requirements.)
4. Remove all resulting debris created by entry hole(s) otherwise electrical components and operation may be affected.

HOW TO ORDER REPAIR PARTS

OUR LARGE SERVICE ORGANIZATION SPANS AMERICA.

Call our TOLL FREE number:

1-800-528-2806