

9

## TorqueMaster® Spring Tube

Tools Required: Safety glasses, Leather gloves

TorqueMaster® springs come lubricated and pre-assembled inside the TorqueMaster® spring tube. To prepare for install, lay the spring tube assembly on the floor, inside garage, in rear of the door, and with the labeled end to the left. Next, remove the shipping boots from the ends of the TorqueMaster® spring tube.

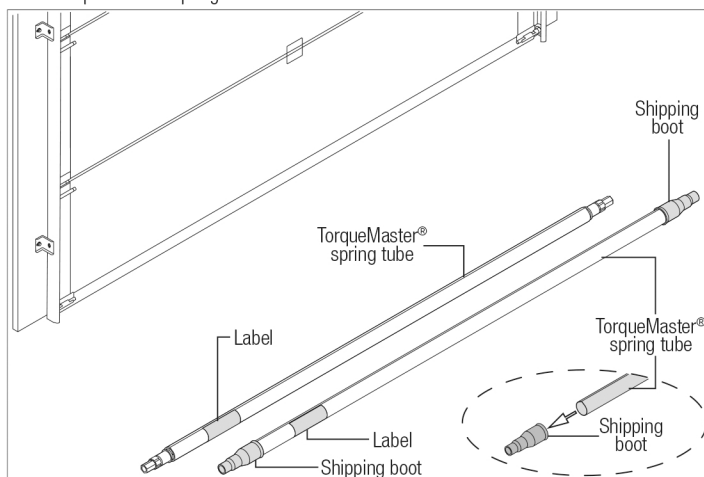

10

## Center Bracket Bushing Assembly

Tools Required: Safety glasses, Leather gloves

Being cam shaped, the center bushing only fits one way. Slide the center bracket bushing assembly towards the center of the TorqueMaster® spring tube, from the right side, as shown.

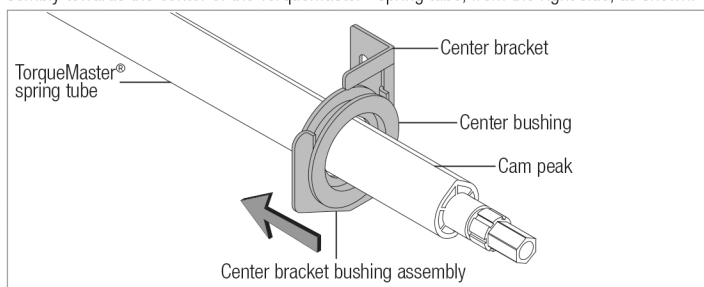

11

## Reinforcing Bracket (if included)

Tools Required: Ratchet wrench, 3/8" Socket, 3/8" Wrench, Step ladder, Safety glasses, Leather gloves

**NOTE:** If reinforcing brackets are included, install them according to these instructions. If reinforcing brackets were not included, skip this step and continue with the TorqueMaster® Spring Tube Installation.

Starting on the left hand side, position the reinforcing bracket on top of the left hand rear support bracket. Insert (2) 5/16" - 18 x 1" hex head bolts through the reinforcing bracket and perforated angle and (2) 5/16" - 18 hex nuts, as shown. Tighten the nuts and repeat for the same process for the right hand side.



**NORTH SHORE**  
COMMERCIAL DOOR .COM  
800-783-6112

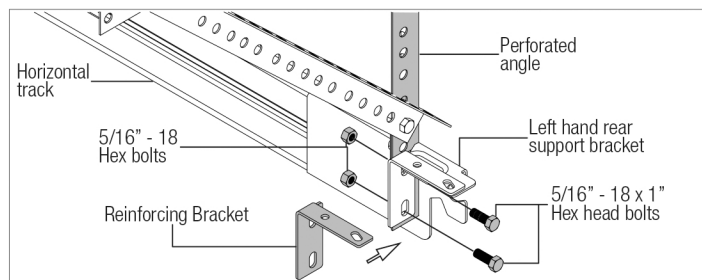

12

## Cable Drum Assemblies

Tools Required: Tape measure, Step ladder, Safety glasses, Leather gloves

Shake the TorqueMaster® spring tube assembly gently to extend the winding shafts out about 5" on each side. For **single spring applications**, there will be no left hand spring in the TorqueMaster® spring tube assembly. Lift the TorqueMaster® spring tube assembly and rest it on top of the rear support brackets.

**NOTE:** Cable drum assemblies are marked right and left hand. Cable drums and TorqueMaster® spring tube assembly are cam shaped to fit together only one way.

Starting on the right hand side, slide the drum wrap over to access the counterbalance lift cable. Pre-wrap the cable drum with the counterbalance lift cable 1-1/2 wraps, as shown.

Position the TorqueMaster® spring tube assembly so the cam peak is pointing towards the door sections. Slide the cable drum over the winding shaft until the cable drum seats against the TorqueMaster® spring tube assembly.

The winding shaft must extend past the cable drum far enough to expose the splines and the grooves. Align the winding shaft grooves with the round notch in the rear support bracket.

**FOR DOUBLE SPRING APPLICATIONS:** Repeat for left hand side.

**FOR SINGLE SPRING APPLICATIONS:** Position and insert the idler bracket into the right hand cable drum, as shown. Lightly press the idler bracket into the cable drum until a distinctive snap is heard.

**IMPORTANT:** ENSURE THE SNAPS ON THE IDLER BRACKET (LEFT HAND SIDE) ARE ENGAGED INTO THE LEFT HAND CABLE DRUM, SO THAT IT DOES NOT COME BACK OUT.

Pre-wrap the left hand cable drum with the counterbalance lift cable 1-1/2 wraps and slide the cable drum over the TorqueMaster® spring tube assembly. Slide the TorqueMaster® spring tube assembly into the cable drum until the cable drum seats up against the TorqueMaster® spring tube assembly.

**NOTE:** The idler bracket must extend past the cable drum far enough to expose the groove.

Align the idler bracket groove with the round notch in the rear support bracket.

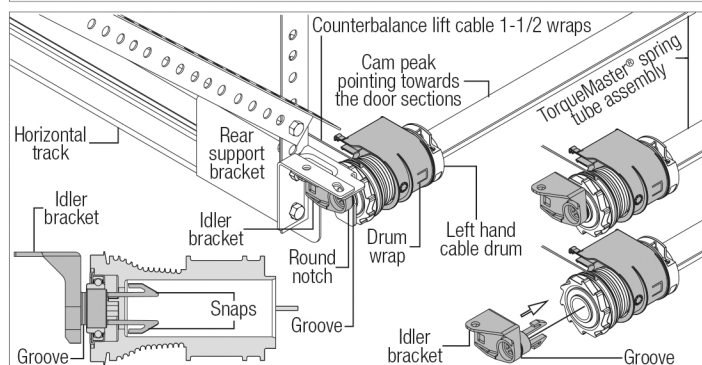
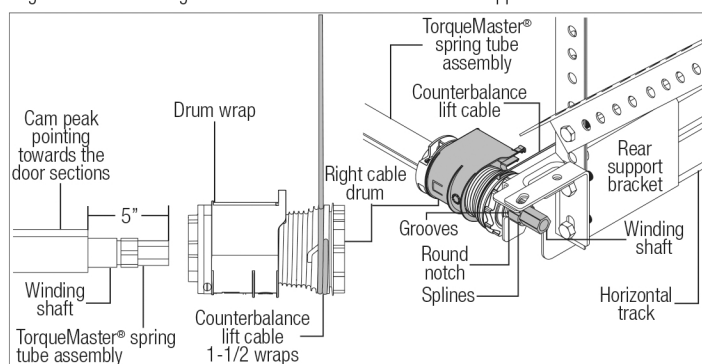

13

## End Brackets

Tools Required: Power drill, 7/16" Socket driver, 1/2" Wrench, Step ladder, Safety glasses, Leather gloves

**IMPORTANT:** WARNING TAGS MUST BE SECURELY ATTACHED TO END BRACKET(S).